

# AMORIM WISE

## INSTALLATION INSTRUCTIONS FOR AMORIM WISE CORK PURE



AMORIM CORK FLOORING

# INSTALLATION INSTRUCTIONS FOR AMORIM WISE CORK PURE

## (Preparation)

### Heated subfloors

For Amorim WISE floors the temperature of the subfloor must not exceed 28°C (82°F). For detailed information, follow the instructions supplied by the subfloor heating system manufacturer/contractor, or contact your supplier.

Remember that rugs or mats placed on top of the floor may function as heat accumulators and will increase the floor surface temperature more than the maximum surface temperature recommended (must not exceed 20-22°C (68°F-72°F)).

Any Heated Subfloor has certain working conditions depending on the heating system and the subfloor.

In order to avoid problems with functioning and durability during the construction phase, the norms and rules concerning installation are to be followed very strictly.

The drying of a heated subfloor has to be made by turning the heating on/off with a pause before installation of the floor, following a documented protocol. After that you can begin the "heating phase".

The beginning of the heating phase in concrete subfloors is to be made not before 21 days after complete curing of the substrate. The heating phase has to begin with running temperature of 25°C (78°F) during 3 days.

The subfloor should be in place and cured for at least 60-90 days.

The temperature should then be increased each day until the maximum temperature allowed according to the manufacturer system. This maximum value should be kept for at least 72 hours and maintained for 5-7 days without turning it off. The decrease of temperature is made by reducing it gradually every day until 18°C (65°F) on the surface is achieved.

During the installation, the temperature of the surface should not exceed 18°C (65°F) and should be kept for 3 days after finishing the installation (for floors). Then the temperature should be increased slowly to a max. of 28°C (82°F) on the subfloor surface.

### Important notes:

- Failure to observe these precautions can cause a build-up of moisture or partial evaporation of the levelling compound or fast drying of adhesive.
- If the heat is turned on when the adhered material has not been conditioned properly on-site for at least 7 days and is not completely dry, the material may shrink. Avoid abruptly turning on radiant heat when cooler weather prevails as it will subject the flooring to rapid movement of expansion and or contraction. Gradually increase temperature regardless of the season.
- The adhesive used must be suitable for heated subfloors.
- All hot water pipes and electrical heating elements should be embedded in concrete in accordance with the appropriate building codes and regulations.
- For detailed information, follow the instructions supplied by the subfloor heating system manufacturer/contractor, or contact your supplier.

## (During installation)

### Protection to humidity

Despite its age, there is always a risk of moisture in subfloors, for that reason it is necessary to ensure that an efficient moisture barrier is installed.

Subfloors must be permanently dry on concrete subfloors without radiant heat. Consider the maximum humidity less than 75% RH or conduct calcium chloride moisture tests to ensure that moisture emission levels are less than 3lbs/1000ft<sup>2</sup>/24 hours (USA and Canada), or CM Test:

Type of Subfloor	Moisture content CM% Heated	Non-heated
Concrete	1,5	2,0
Anhydrite	0,3	0,5

### Tools

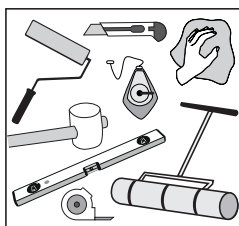

Tape measure, craft knife, pencil, straight edge, chalk line, trowel or pressor roller.

### Measure

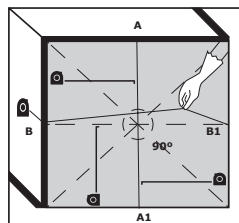

Find the centre of the room using a chalk line, from the middle of wall A to the middle of A1. Then make a line from the middle of wall B to the middle of wall B1. Check that the intersection of the two lines forms a 90° angle.

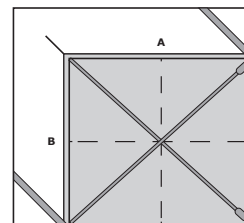

Check the room dimension by measuring or placing the tiles (without gluing) from the middle. Make sure that the widths of the tiles that will be near the wall are equal or bigger than 5cm (2"). If necessary repeat the previous step by drawing new parallel lines to the first ones.

## (Prior to installation)

### Transportation

Transport and store the cartons horizontally.

Packed tiles and adhesive should be acclimatized at the job site in a dry, well-ventilated area for a minimum of 48 hours so that flooring may acclimate.

Remove tiles from packages just before start installation.

During storage and installation, maintain temperature and relative humidity to a level consistent with the conditions which will prevail when the building is occupied. In most cases, this means maintaining a temperature range from 18°C to 28°C (65°F to 82°F) and relative humidity range from 35% to 65%.

### Site inspection

Prior to installation, please inspect the tiles in daylight for any visible faults or damage, and also check if the subfloor and site conditions are in accordance with the specifications described within these instructions.

Amorim Cork Flooring cannot be held responsible for claims associated with improper subfloors, improper applications, adhesives, varnishes and the use of maintenance products not recommended, or detectable defects verifiable prior to installation.

### Recommended adhesive

Amorim WISE recommends adhesives specially developed for ease of use, safety and quality of the application.

For the correct use follow the instructions on the packaging labels of each product, as well as the information from technical data sheets.

To be aligned with Amorim WISE commitment to wellbeing, we recommend the use of auxiliary products (levelling compounds, primers, adhesives or varnishes) that have low-emissions to the environment.

Recommended adhesives for Glue-down floors: WICANDERS W-240.

# INSTALLATION INSTRUCTIONS FOR AMORIM WISE CORK PURE



Contact Adhesive: This adhesive should be applied to the subfloor and also to the tiles.  
Stir the adhesive well, before using.

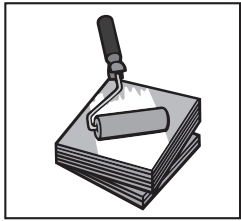

1

Apply the Amorim WISE W240 Contact adhesive with a mohair short hair roller to the backing of the cork tiles  
Coverage should be 150g/m<sup>2</sup> on the tile

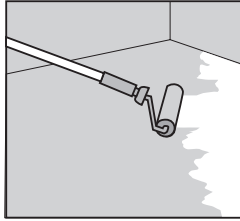

2

Apply the adhesive with a mohair roller to the subfloor.  
Coverage should be 150 gr/m<sup>2</sup>  
Avoid pooling of adhesive.\*

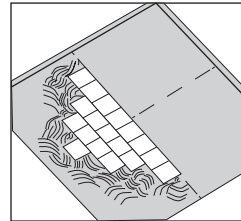

3

Install the tiles from the center along the marked line, preferably using "brick-bond" installation.

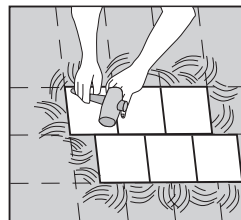

4

Press each tile with the help of a rubber hammer or hand roller.  
Remove any excess adhesive with a damp cloth.

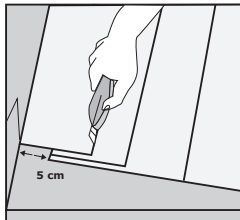

5a

Cut the tiles near the wall as indicated.

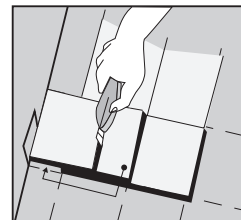

5b

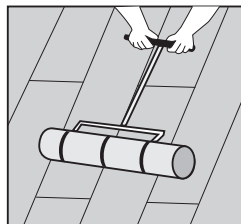

6

The floor must be rolled with a 50-Kg roller, every 30 minutes, and upon completion of installation, to ensure that the tiles are firmly bedded into the adhesive

\*Note: 1 gal. covers 180 sqft. when covering both the tile and the floor  
Let the adhesive dry completely (after it has dried the adhesive becomes transparent).  
Drying time on the subfloor is 40 - 60 minutes, depending on the temperature and the relative humidity on site.

Amorim Cork Flooring S.A  
(+351) 227 475 600

[www.amorimwise.com](http://www.amorimwise.com)